

# great american kitchens

The Fine Art of Kitchen Design

VOLUME III



**51**  
Award-Winning  
Rooms

U.S. \$15.95 / CANADA \$19.95





*cool ideas!*

- lightning-bolt motif
- zigzag soffit trim
- hand-painted tiles
- concrete floor
- custom cat door

# southwestern revival



PHOTOGRAPHY: © ROBERT RECK; STYLING: ELAINE ROY

■ Near the banks of the Rio Grande in Albuquerque, New Mexico is a new adobe house designed by architect Rick Ansaldi, of Ansaldi/Shaw Design in Tucson. The exterior, complete with a tall structure that suggests a Mission bell tower, captures the look of old New Mexico. The challenge for designer Kathy Jackson, of J. Wheeler & The Branch Cabinetry in Albuquerque, was to update the adobe aesthetic to meet the owners' request for a contemporary kitchen full of color and character.

Because the kitchen is accessed from three different rooms, Jackson paid careful attention to the traffic pattern. "I kept the aisles wide and laid out the room so that people can walk through the kitchen to the family room without interfering with the work area," she explains. ➔

**Left:** The Sub-Zero Model 642 refrigerator/freezer and 700 Series tall freezer flank the main work areas. Metal inserts in some of the cabinet doors reference the appliances' stainless-steel cladding. **Opposite:** The carved door, lightning-bolt cabinet panels, and corner posts of the island are all traditional Southwestern elements. A skylight in front of the plaster archway contributes natural light.







## The kitchen meets everyone's needs, even the four-footed members of the family.

The homeowners, a couple with a teenage daughter, like to cook as a family. In response, Jackson established two distinct yet overlapping work triangles, each anchored by the Sub-Zero Model 642 refrigerator/freezer. The cooking triangle includes a 48-inch-wide cooktop and two wall ovens, and a double stainless-steel sink in the island. The food preparation triangle includes another double stainless-steel sink, as well as a built-in microwave. The Sub-Zero 700 Series tall freezer conveniently stores frozen foods nearby. There are also two dishwashers and two warming drawers.

Decorative elements in the kitchen draw inspiration from several sources. "The owners saw a photograph in a Santa Fe museum

by Jesse Nusbaum, a mid-20th century archaeologist and photographer for the National Park Service, who studied ancient Southwestern civilizations," says Jackson. "They wanted design elements from that photo to be reflected in the kitchen. We incorporated the contemporary lightning-bolt motif in the custom maple cabinetry and twisted carved corner posts of the island."

In her pursuit of color, the homeowner selected the hand-painted tiles that appear in the kitchen and throughout the rest of the house with Jenny Lind of Rainbow Gate, in Santa Fe. Blue-painted window frames contribute additional strokes of color to the interior. Contemporary textural elements include the earth-toned concrete

**Near right:** In the breakfast area, the built-in plaster banco has a sloped back for seating comfort. The table overlooks the patio, which includes an outdoor kitchen. A serape and rustic chair add colorful notes.

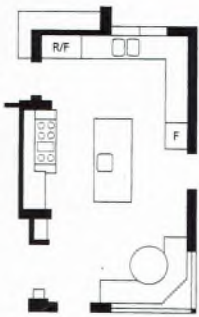



floor, the granite countertops, and stainless-steel screen inserts in several of the maple cabinet doors.

Updates on traditional New Mexican styling appear in the plaster archway that frames the cooktop area and the echoing tiled arch beneath the cooktop. Seeded-glass inserts adorn the upper portions of the wall cabinets. Painted a soft green, the vintage-look bead-board ceiling carries through to the adjoining butler's pantry.

As well as offering additional storage and space for the washer and dryer, the butler's pantry is the feeding station for the family's cats and dog. Litter boxes hide in cabinets beneath the pantry sink, accessible through a whimsical cutout in a pair of doors.

The kitchen's 12-foot ceiling features an ample skylight in front of the archway that frames the cooktop area. A pair of windows over the main sink that overlooks the entry courtyard brings in additional light, as does another window over the eating *banco* that furnishes a view into the rear patio. In the evening, illumination comes from recessed downlights in the ceiling and cobalt-blue pendants suspended above the island.

"What I enjoy most is that although it's a big kitchen, it's an efficient space," says the homeowner, who is not only the primary cook, but also a contractor herself. "I worked with superb designers and all of them were committed to the project."—*Wanda Jankowski*



**Above:** The semicircular tiled alcove beneath the cooktop mimics the archway above it. **Above right:** In the butler's pantry, a playful cutout accesses the cats' litter boxes.

